

# *Service Letter*

## **Service Letter No. 426 February, 1995**

**SUBJECT: New Auto-Lash® Assembly**

### **MODELS AFFECTED: 340A**

A new Auto-Lash Adjusting Screw Assembly for Caterpillar 3406E engines will be used in the Model 340A engine brake housing assemblies and will be available as a service part as noted below:

<b>Engine Model</b>	<b>Existing Auto-Lash Part Number</b>	<b>New Auto-Lash Part Number</b>	<b>Color Code</b>	<b>Effectivity Date</b>
340A	018015	020538	None	Immediately, starting with engine brake S/N AE096518

The new Auto-Lash Adjusting Screw Assembly for Caterpillar engines (P/N 020538) will continue to have a slotted head. The crosspin on the assembly has been removed and replaced by a pressed sleeve. These parts are interchangeable and both styles can be used in a Jacobs engine brake housing assembly.

This is a Jacobs product improvement and not subject to campaign.

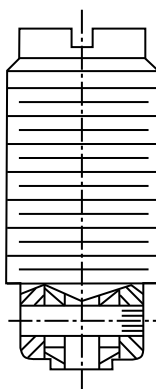

**Current Style  
P/N 020538**